

## Exhaust fans EAT series

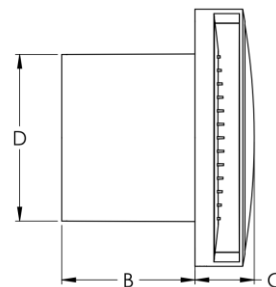
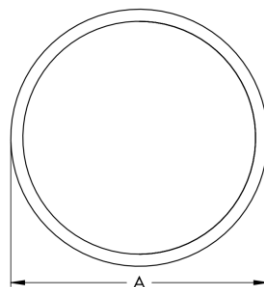

### Product description

Exhaust fans for walls or ceiling mounting of premises.

Construction	Manufactured from plastic Fan: axial Type of bearing: ball bearing Motor protection class: IPX4
Installation	Mounting with all type round ducts: sheet metal, flexible aluminum, plastic or fabric. Mounting positions: multiple Location: indoors
Power supply	230V-50Hz single phase
Temperature range	+ 5°C to + 40°C
Sizes	100, 125, 150 mm

DIMENSIONS [mm]				
Type	A	B	C	D
EAT100	152	80	35	99
EAT125	178	80	35	124
EAT150	203	80	35	149

## Exhaust fans EAT series

### Technical data

Type	Voltage [V-Hz]	Power [W]	IP	Speed [rpm]	Air flow [m <sup>3</sup> /h]	Noise level: 3m distance, Lp A dB(A)	Temperature min/max [°C]	Weight [kg]
EAT100	230V-50Hz	15	IPX4	2550	100	32	+5/+40	0,42
EAT125	230V-50Hz	16	IPX4	2360	150	36	+5/+40	0,49
EAT150	230V-50Hz	20	IPX4	2100	200	40	+5/+40	0,61

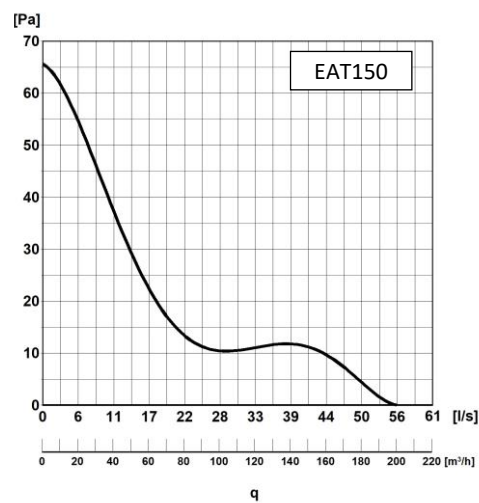
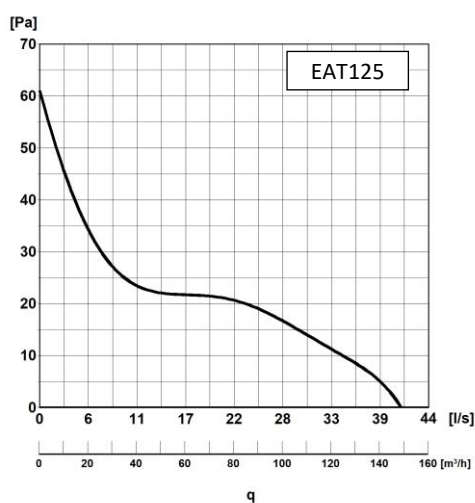
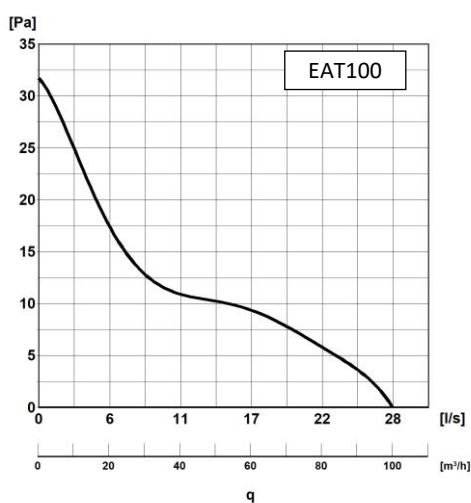

### Modifications

EATxxxT - fan is equipped with a timer function

EATxxxHT - fan is equipped with a humidity level control function

### Colors

EATxxxA – anthracite

EATxxxS – silver

EATxxxG – gold